

# REBLOC 80S\_12

## Technical Datasheet

REBLOC 80S\_12

Precast Concrete  
Vehicle Restraint System

Temporary System  
Free standing

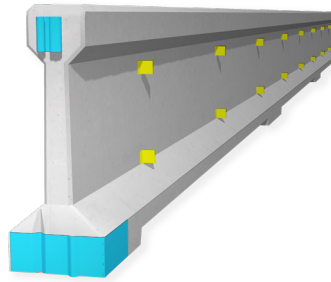

### Technical data

Test level	TL3
Working width	63.0 in (1.6 m)
Dynamic deflection	44.4 in (1.1 m)
Installation	free standing on asphalt   concrete
Application	single-sided   double-sided
Minimum installation length	276 ft (84 m; 7 elements) + initial/end anchorage
Initial/end anchorage	required: e.g. REBLOC 80S_4CRC for the connection of attenuators (4 x screwbolts Ø 16/150 mm in asphalt) or force closure
Dimensions L x W x H	472.4 x 11.8 x 31.5 in (1200 x 30 x 80 cm)
Weight/element	approx. 6614 lb (3000 kg)
Curve radius	$r \geq 853$ ft (260 m)
Coupling/exposed steel parts	fully integrated, exposed parts hot-dip galvanized
Features	rubber pads in contact areas for protection of the road surface

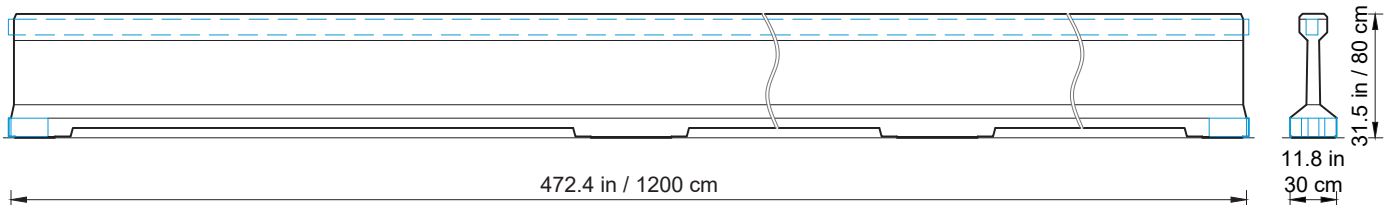

all dimensions in cm